

Roll Up Banner Instructions

Graphic installation

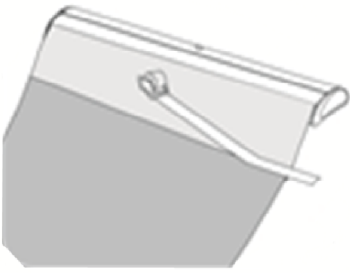

1. peel off the adhesive paper from the edge of the base's leader roll

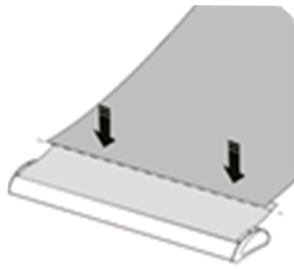

2. attach the bottom of the banner

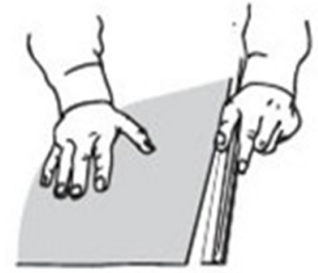

3. install the snap top bar to the graphic

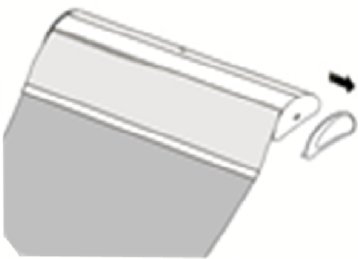

4. peel off the cover of the right side



5. activate the spring tension by removing the Allen Key

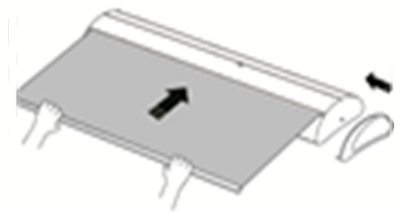

6. carefully allow the graphic to recoll into the base unit, then reattach the cover

Roll up instruction

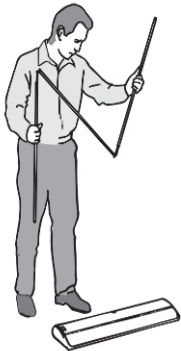

1. insert the assembled pole to the base hole



2. pull up the graphic carefully

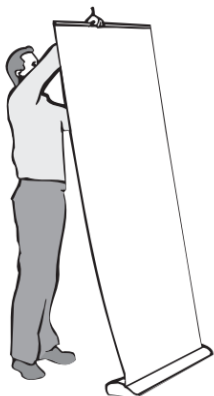
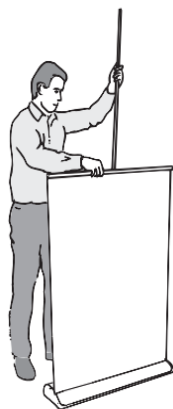

3. fix the hook of beam top bar to the 3-sectioned pole

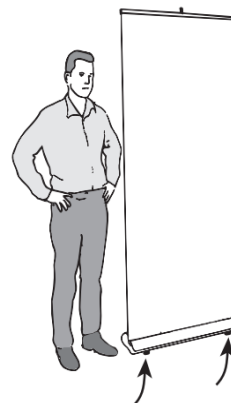
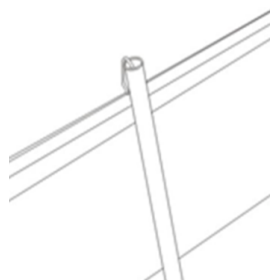

4. the unit can be leveled by adjusting the plastic screws at the bottom of the base